

Application Systems

Optics & Optical Coatings

Holders

Bases

Manual Stages

Actuators

Motorized Stages

Light Sources

Index

Micrometer Heads

Differential Micrometer Heads

Fine-pitch Screws

Remote

PKA

OptiMike

ACT

Suitable as direct replacements brackets of micrometer heads used on Sigma Koki manual stages. Elimination of knobs saves space and prevents inadvertent operation.

- The screw bushing has a lock mechanism.
- The flat-type tip is compatible with Sigma Koki manual stages and holders, enabling specification changes.
- Use a hex wrench with knob (KCL) or your hex wrench for adjustment.



Guide

- ▶ Can be purchased assembled with manual stage. Contact our International Sales Division for more information.

Attention

- ▶ Consider the object before replacing the flat-type tip with the R-type tip.



Example of combination with stage

Hex Wrench with Knob

KCL-203

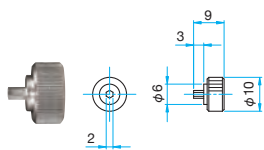

KCL-304

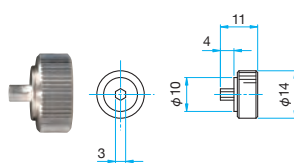

Specifications

Part Number	Compatible Products
KCL-203	FPSA-42525(R)
KCL-304	FPSA-62540(R)/FPSA-62550(R)/FPSA-62555(R)

Part Names and Handling Instructions

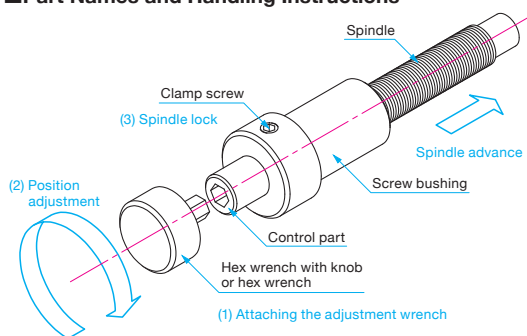

- (1) Attaching the adjustment wrench**
Attach the hex wrench or hex wrench with knob.
- (2) Position adjustment**
Adjust the position by turning the wrench.
- (3) Spindle lock**
Lock the spindle with the clamp screw.

Hex wrench used

Part Number	FPSA-42525(R)	FPSA-62540(R)/62550(R)/62555(R)
Control Part	Wrench size for adjustment: B=2	Wrench size for adjustment: B=3
Clamp Lock	Wrench size for clamp: B=1.5mm	



Length 25mm



Length 40mm

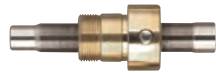

Length 50mm

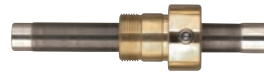

Length 55mm



Tip Shape/Flat Type

FPSA-42525

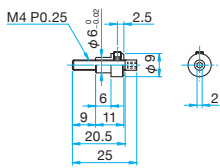

FPSA-62540

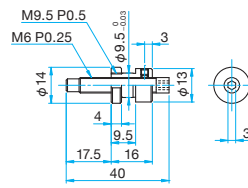

FPSA-62550

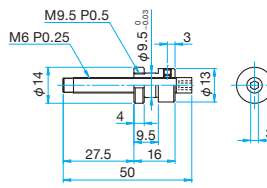

FPSA-62555

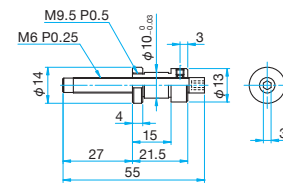

Specifications

Part Number	Screw	Pitch [mm]	Length [mm]	Bush Diameter [mm]	Bush Length [mm]	Load Capacity (Static load) [N]	Weight [kg]
FPSA-42525	M4	0.25	25	6.0	6.0	29.4 (3kgf)	0.005
FPSA-62540	M6	0.25	40	9.5	5.5	39.2 (4kgf)	0.019
FPSA-62550	M6	0.25	50	9.5	5.5	39.2 (4kgf)	0.021
FPSA-62555	M6	0.25	55	10.0	11.0	39.2 (4kgf)	0.025

Tip Shape/R Type

FPSA-42525R

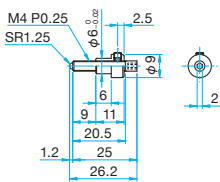

FPSA-62540R

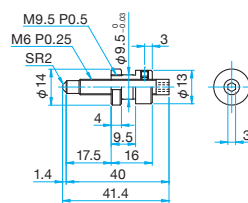

FPSA-62550R

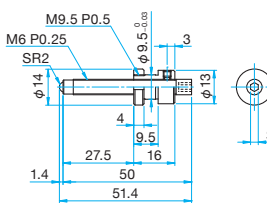

FPSA-62555R

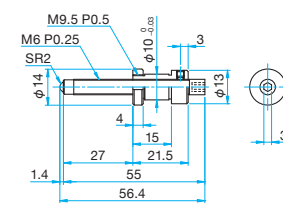

Specifications

Part Number	Screw	Pitch [mm]	Length [mm]	Bush Diameter [mm]	Bush Length [mm]	Load Capacity (Static load) [N]	Weight [kg]
FPSA-42525R	M4	0.25	26.2	6.0	6.0	29.4 (3kgf)	0.005
FPSA-62540R	M6	0.25	41.4	9.5	5.5	39.2 (4kgf)	0.019
FPSA-62550R	M6	0.25	51.4	9.5	5.5	39.2 (4kgf)	0.021
FPSA-62555R	M6	0.25	56.4	10.0	11.0	39.2 (4kgf)	0.025

Application Systems

Optics & Optical Coatings

Holders

Bases

Manual Stages

Actuators

MotORIZED Stages

Light Sources

Index

Micrometer Heads

Differential Micrometer Heads

Fine-pitch Screws

Remote

PKA

OptMike

ACT