

Post Stand Guide

It is available for a fine-tune to any height, by using a post stand with the lineup of 15 – 76.2mm height and a dedicated spacer.



Application Systems
Optics & Optical Coatings
Holders

Bases

Manual Stages

Actuators

Motoeized Stages

Light Sources

Index

Guide

Vibration Isolation Systems

Optical Tables

Darkrooms/
Dark Boxes

Optical Bases

Posts

Brackets

Adapters

Tools

Pedestal Bases | PST

<Connection Example>

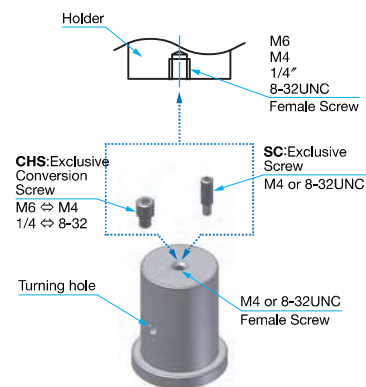

Holder Side	Supplied Screw	Post Stand Side
M6	CHS-M4-M6-9	M4
M4	SC-M4-18EE	M4
1/4"	CHS-1/4-8U-9	8-32UNC
8-32	SC-8U-18UU	8-32UNC

Small Pedestal Bases | SPS

<Connection Example>

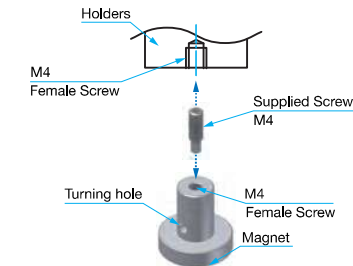

<SPT/SPS Usage Example>

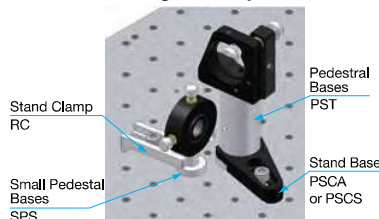

Stand Bases | RCA

It is the stand base suitable to the rod stand (RS, BRS). It can be freely placed in a limited space.

<Connection Example>

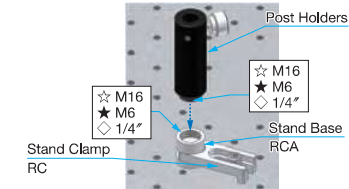

<Usage Example>



Small Pedestal Adapters | PS-SP

The spacer for a post stand is used as a height adjustment spacer placed on the post stand.

● Our post stand (PS series) has a lineup at 5 mm intervals. The PS-SP series can be used to adjust the fine height of 0.5–4.5 mm.

■ Combination of Small Pedestal Adapters (PS-SP series) and Screw (SC series) Reference D041, D050

PS-SP Height [mm]	Combined Use Case (Part number)	Available SC screw Length [mm]	Protruded Screw Height [mm]
0.5	PS-0.5SP	17.5	4
1	PS-1SP	17.5	3.5
1.5	PS-0.5SP+PS-1SP	17.5	3
2	PS-2SP	19.5	4.5
2.5	PS-0.5SP+PS-2SP	19.5	4
3	PS-1SP+PS-2SP	19.5	3.5
3.5	PS-0.5SP+PS-1SP+PS-2SP	21	4.5
4	PS-2SP×2	21	4
4.5	PS-0.5SP+PS-2SP×2	21	3.5

● The height of optical axis of our holder has been designed in millimeters (mm). If you want to set inch size, the post stand for spacer (PS-SPUU series) can be used.
(Example) 2 "[50.8 mm] (optical axis height) = 25 mm (holder optical axis height) +25 mm (post stand height) +0.8 mm (spacer thickness for post stand thickness)

■ Using the post stand for spacer (PS-SPUU series)

Optical Axis Height		Available Spacer (Part number)
[INCH]	[mm]	
1.5	38.1	PS-3.1SPUU
2	50.8	PS-0.8SPUU
2.5	63.5	PS-3.5SPUU
3	76.2	PS-1.2SPUU
3.5	88.9	PS-3.9SPUU
4	101.6	PS-1.6SPUU
4.5	114.3	PS-4.3SPUU

Posts holders Pedestal Clamps

PST
PSC/PSCA/PSCS

PST

RoHS Catalog Code W6039

Pedestal Bases can be mounted directly on a vibration isolator or laboratory bench and are ideal for flexible positioning of optical units with low optical axis.



Outline Drawing

PST

- Dog Point Set Screws SC-M4-18EE...1 screws, M4-M6 Conversion screw CHS-M4-M6-9...1 screws (METRIC)
- Dog Point Set Screws SC-8U-18UU...1 screws, 8-32-1/4 Conversion screw CHS-1/4-8U-9...1 screws (INCH)

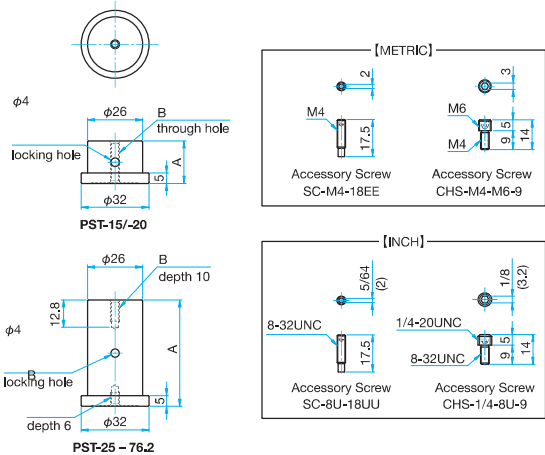

Part Number		Primary material: Stainless Steel Finish: None	
METRIC	INCH	A [mm]	Weight [kg]
B=M4	B=8-32UNC		
PST-15	PST-15UU	15	0.07
PST-20	PST-20UU	20	0.08
PST-25	PST-25UU	25	0.1
PST-25.4	PST-25.4UU	25.4	0.1
PST-30	PST-30UU	30	0.12
PST-35	PST-35UU	35	0.15
PST-38.1	PST-38.1UU	38.1	0.16
PST-40	PST-40UU	40	0.17
PST-45	PST-45UU	45	0.19
PST-50	PST-50UU	50	0.21
PST-50.8	PST-50.8UU	50.8	0.21
PST-55	PST-55UU	55	0.23
PST-60	PST-60UU	60	0.25
PST-63.5	PST-63.5UU	63.5	0.26
PST-76.2	PST-76.2UU	76.2	0.31

PSC/PSCA/PSCS

RoHS Catalog Code W6040

Clamps for Pedestal Bases (PST). Used in combination with a Pedestal, the Pedestal can be freely positioned and secured on a vibration isolator or laboratory bench.

- The PSC-10 is used in pairs, for clamping a Pedestal at two positions, and the PSCA / PSCS is used for clamping at a single position.
- Since there is a long hole in the PSCA / PSCS, it is possible for coarse adjustment of the horizontal direction.
- After alignment, tighten the attached M6 screw to secure the Pedestal.



Outline Drawing

PSC-10/10UU

PSCA/PSCS

- Hexagon socket head cap screw (stainless steel construction) M6x12...1 screws (METRIC)
- Hexagon socket head cap screw (stainless steel construction) 1/4-20UNCx1/2...1 screws (INCH)

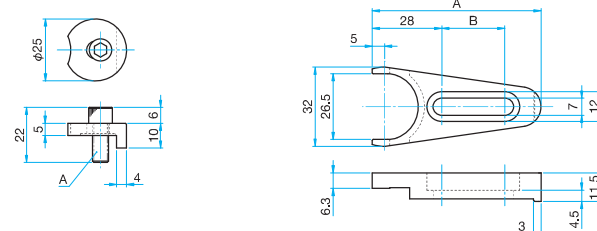

Part Number		Primary material: Stainless Steel Finish: None	
A	Weight [kg]		
PSC-10	M6 P1	0.065	
PSC-10UU	1/4-20UNC	0.065	

Part Number		Primary material	Finish	Weight [kg]
METRIC	INCH			
PSCA-11.5	PSCA-11.5UU	Aluminum	Black Anodized	0.02
PSCS-11.5	PSCS-11.5UU	stainless Steel	None	0.06

Part Number	A (mm)	B (mm)
PSCA-11.5/11.5UU	60	22
PSCS-11.5/11.5UU	68	25.4

Application Systems

Optics & Optical Coatings

Holders

Bases

Manual Stages

Actuators

MotORIZED Stages

Light Sources

Index

Guide

Vibration Isolation Systems

Optical Tables

Darkrooms/ Dark Boxes

Optical Bases

Posts

Brackets

Adapters

Tools

Adapter Plates for Pedestal / Pedestal Adapters Small Pedestal Base / Small Pedestal Adapters

SP-T / PS-SP
SPS / SPS-SP

SP-T

RoHS Catalog Code W6041



Auxiliary parts for Pedestal Bases. Secured on top of a Pedestal for height adjustment of part of a small optical system or an optical unit.

- Used in combination with a Pedestal and Pedestal clamp.
- The SP-25T is designed primarily for □25mm stages with M2 mounting holes, and the SP-40T is designed primarily for □25mm and □40mm stages with M2 and M3 mounting holes.

Guide

- ▶ Use pedestal adapters (PS-SP) for fine height adjustment that cannot be managed with adapter plates for pedestal.
- ▶ Custom sizes or shapes not listed in the catalog. Contact our International Sales Division for more information.

Specifications		Primary material: Aluminum Finish: Black Anodized
Part Number		Weight [kg]
SP-25T		0.009
SP-40T		0.02

Outline Drawing

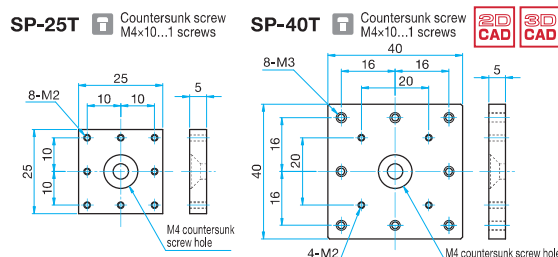

PS-SP

RoHS Catalog Code W6042

- Auxiliary spacer plates for pedestal (SP-T). This product enables fine adjustment that cannot be managed with adapter plates for pedestal.
- Attached between the Pedestal and adjustable adapter kits, and tightened together.

Outline Drawing

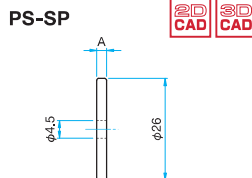

Guide

- ▶ Custom sizes or shapes not listed in the catalog. Contact our International Sales Division for more information.

Specifications		Primary material: Aluminum Finish: Black Anodized
Part Number	A [mm]	Weight [kg]
PS-0.5SP	0.5	0.002
PS-0.8SPUU	0.8	0.003
PS-1SP	1	0.004
PS-1.2SPUU	1.2	0.005
PS-1.6SPUU	1.6	0.006
PS-2SP	2	0.008
PS-2.5SPUU	2.5	0.01
PS-3.1SPUU	3.1	0.012
PS-3.5SPUU	3.5	0.014
PS-3.9SPUU	3.9	0.016
PS-4.3SPUU	4.3	0.017

SPS

RoHS Catalog Code W6079

Small post stand is suitable for connection of an adaptive optics mount holder of φ15 mm or less.

- It is easy to make any positioning and is fixed by post clamp (RC series).
- As an optical unit of low optical axis, it can be placed directly on the vibration isolator and optical bench.



Specifications		Primary material: Aluminum Finish: Black Anodized
Part Number	A [mm]	Weight [kg]
SPS-12.5	12.5	0.01
SPS-15	15	0.013
SPS-20	20	0.017

Outline Drawing

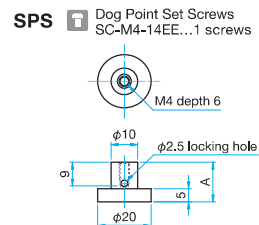

SPS-SP

RoHS Catalog Code W6080

As a spacer for small post stand, it corrects the deviation of the height of the optical axis. Placing between the post stand and optical element mount holder, it is used after fixing with fastened together.



Specifications		Primary material: Aluminum Finish: Black Anodized
Part Number	A [mm]	Weight [kg]
SPS-0.5SP	0.5	0.0007
SPS-1SP	1	0.0015
SPS-2SP	2	0.003

Outline Drawing

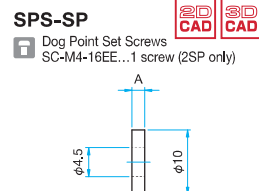

Application Systems

Optics & Optical Coatings

Holders

Bases

Manual Stages

Actuators

Motoeized Stages

Light Sources

Index

Guide

Vibration Isolation Systems

Optical Tables

Darkrooms/ Dark Boxes

Optical Bases

Posts

Brackets

Adapters

Tools

High Stability Ball Plunger Post Holders | BRS

BRS



Catalog Code W6043

Application Systems

Optics & Optical Coatings

Holders

Bases

Manual Stages

Actuators

Motoeized Stages

Light Sources

Index

Guide

Vibration Isolation Systems

Optical Tables

Darkrooms/ Dark Boxes

Optical Bases

Posts

Brackets

Adapters

Tools

Used for height and rotational coarse/fine adjustment of a post-equipped holder. The hole shape was modified to hold a post with two lines and one point instead of one line and one point, offering improved holding stability compared to our conventional products.



- Fitted with a plunger to gently hold to post while the clamp is loosened, enabling smooth adjustment with one hand.
- By adjusting the screw pin at the bottom of post holder, the angle can be changed 90 degrees.
- Can be fixed on various places with replacement or addition of optional parts.

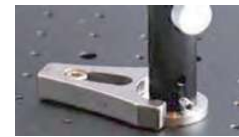
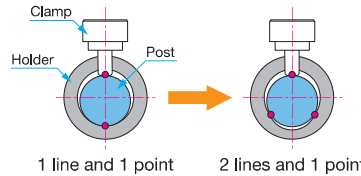

Guide

▶ Clamp screws (RS-CB) can be purchased separately. [Reference](#) D045



Outline Drawing

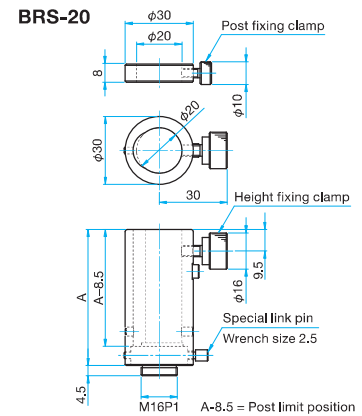
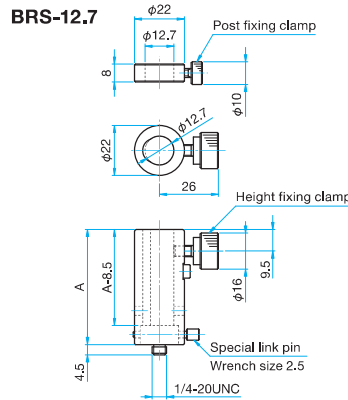
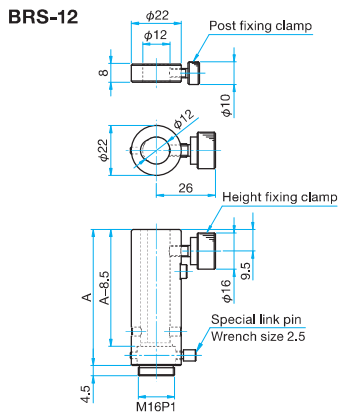

Inner Diameter: 12 Primary material: Aluminum Finish: Black Anodized

Part Number	A [mm]	Weight [kg]
BRS-12-30	30	0.05
BRS-12-40	40	0.06
BRS-12-50	50	0.07
BRS-12-60	60	0.08
BRS-12-80	80	0.1
BRS-12-100	100	0.12
BRS-12-120	120	0.14
BRS-12-130	130	0.15

Inner Diameter: 12.7 Primary material: Aluminum Finish: Black Anodized

Part Number	A [mm]	Weight [kg]
BRS-12.7-25.4UU	25.4	0.04
BRS-12.7-38.1UU	38.1	0.06
BRS-12.7-50.8UU	50.8	0.07
BRS-12.7-63.5UU	63.5	0.08
BRS-12.7-76.2UU	76.2	0.1
BRS-12.7-101.6UU	101.6	0.12
BRS-12.7-127UU	127	0.15
BRS-12.7-152.4UU	152.4	0.18

Inner Diameter: 20 Primary material: Aluminum Finish: Black Anodized

Part Number	A [mm]	Weight [kg]
BRS-20-30	30	0.07
BRS-20-40	40	0.09
BRS-20-50	50	0.1
BRS-20-60	60	0.12
BRS-20-80	80	0.16
BRS-20-100	100	0.19
BRS-20-120	120	0.22
BRS-20-130	130	0.24

Option Adapters for High Stability Type Post Holders | BRS

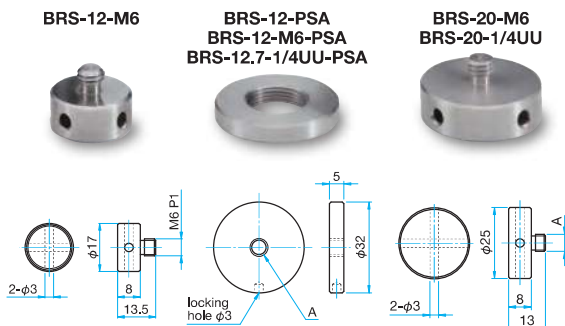

- Optional parts for high stability ball plunger post holders (BRS).
- M6×P1 conversion adapter (BRS-**-M6) is required for directly securing on a vibration isolator.

Specifications Primary material: Stainless Steel Finish: None

Part Number	Compatible Post Holders	A	Weight [kg]
BRS-12-M6	BRS-12	-	0.013
BRS-12-PSA	BRS-12	M6 P1	0.023
BRS-12-M6-PSA	BRS-12	M6 P1	0.02
BRS-12.7-1/4UU-PSA	BRS-12.7	1/4-20UNC	0.02
BRS-20-M6	BRS-20	M6 P1	0.03
BRS-20-1/4UU	BRS-20	1/4-20UNC	0.03

Used for height and rotational coarse adjustment of a post-equipped holder.



- To secure a holder, insert the post into the post holder, and clamp it using the clamp screw on the side and that of the intermediate ring on top.
- Loosening the clamp screw on the side of the main body while leaving that of the intermediate ring tightened allows coarse rotational adjustment around the vertical axis.
- With three tapped holes provided on the side of the main body for the clamp screw, it is possible to move the clamp screw to where it needs to be after setting up the post holder. (Note that the RS-30 model comes with three clamp screws as standard.)
- Fitted with an air-vent hole, enabling easy loading/unloading of a post.

Guide

▶ Intermediate rings (TR) and clamp screws (RS-CB) can be purchased separately. [Reference](#) D044, D045



Outline Drawing

RS-6

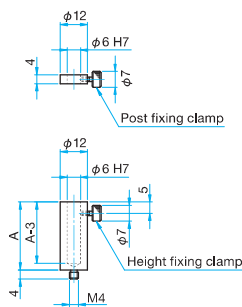

RS-12

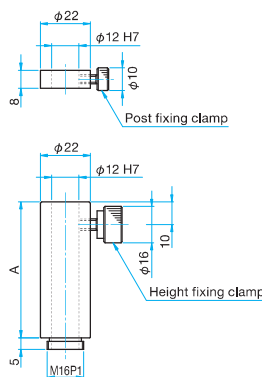

RS-20

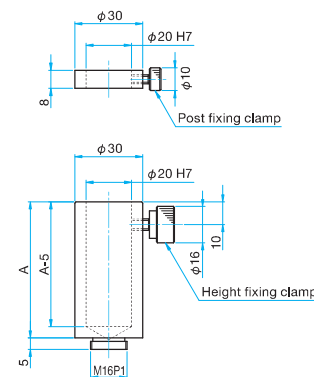

Inner Diameter: 6		Primary material: Aluminum Finish: Black Anodized
Part Number	A [mm]	Weight [kg]
RS-6-15	15	0.008
RS-6-20	20	0.009
RS-6-25	25	0.01
RS-6-30	30	0.011
RS-6-35	35	0.012
RS-6-40	40	0.013

Inner Diameter: 12		Primary material: Brass Finish: Black matte
Part Number	A [mm]	Weight [kg]
RS-12-30	30	0.1
RS-12-35	35	0.12
RS-12-40	40	0.13
RS-12-45	45	0.14
RS-12-50	50	0.15
RS-12-55	55	0.16
RS-12-60	60	0.17
RS-12-80	80	0.22
RS-12-100	100	0.26
RS-12-120	120	0.3
RS-12-130	130	0.32

Inner Diameter: 20		Primary material: Brass Finish: Black matte
Part Number	A [mm]	Weight [kg]
RS-20-30	30	0.16
RS-20-35	35	0.17
RS-20-40	40	0.19
RS-20-45	45	0.21
RS-20-50	50	0.22
RS-20-55	55	0.24
RS-20-60	60	0.26
RS-20-80	80	0.32
RS-20-100	100	0.38
RS-20-120	120	0.45
RS-20-130	130	0.48

Application Systems
Optics & Optical Coatings
Holders

Bases

Manual Stages

Actuators

Motoeized Stages

Light Sources

Index

Guide

Vibration Isolation Systems

Optical Tables

Darkrooms/
Dark Boxes

Optical Bases

Posts

Brackets

Adapters

Tools

Stand Base/Stand Clamp C shape intermediate ring

RCA/RC
TRC

RCA/RC

RoHS Catalog Code W6081

Application Systems

Optics & Optical Coatings

Holders

Bases

Manual Stages

Actuators

Motoeized Stages

Light Sources

Index

Guide

Vibration Isolation Systems

Optical Tables

Darkrooms/ Dark Boxes

Optical Bases

Posts

Brackets

Adapters

Tools

The base can be used to secure the rod stand in a small space.

- Rod stand base with a magnet and space-saving clamp to secure this stand base.
- Clamp for M6 taps with 25mm centers (RC-10-17) and clamp for M6 taps with 50mm centers (RC-10-25) are available.



Outline Drawing

RCA

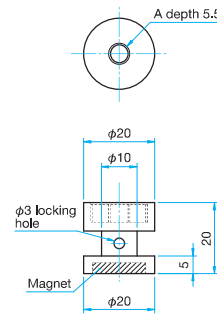

Part Number	A (mm)
RCA-M16	M16 P1
RCA-M6	M6
RCA-UU	1/4-20UNC

RC-10-17/25

Hexagon socket head cap screw (stainless steel construction) M6x15...1 screws, Flat washer

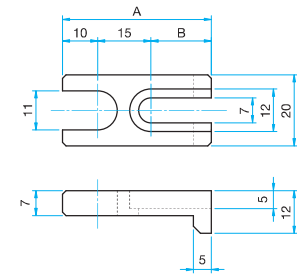

Part Number	A (mm)	B (mm)
RC-10-17	42	17
RC-10-25	50	25

Specifications

Primary material: Stainless Steel
Finish: None

Part Number	Product Name	To hold	Mounting	Weight [kg]
RCA-M16	Stand Base	M16 Rod Stand	Magnet, Stand Clamp (RC-10)	0.023
RCA-M6	Stand Base	M6 Rod Stand	Magnet, Stand Clamp (RC-10)	0.035
RCA-1/4UU	Stand Base	1/4 INCH Rod Stand	Magnet, Stand Clamp (RC-10)	0.035
RC-10-17	Stand Clamp	Stand Base (RCA-M16)	Hexagon socket head bolt M6x15	0.027
RC-10-25	Stand Clamp	Stand Base (RCA-M16)	Hexagon socket head bolt M6x15	0.031

TRC

RoHS Catalog Code W6082

Accessory parts for posts (RO)

- Prevent falling the post mounted on the post holders.
- C shape intermediate ring can be installed and fix the post after adjusting the height of optical path with holders.



Specifications

Primary material: Aluminum
Finish: Black Anodized

Part Number	Inner Diameter [mm]	Quantity [Pieces]
TRC-12	φ12	5
TRC-12.7	φ12.7	5
TRC-20	φ20	5

Guide

- ▶ Contact our International Sales Division if the standard intermediate ring equipped with the post is needed to be replaced with the C shape intermediate ring.

Attention

- ▶ This product is delivered only by mail.



Outline Drawing

TRC-12/12.7

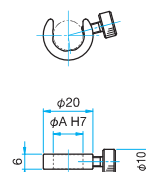

Part Number	A (mm)
TRC-12	12
TRC-12.7	12.7

TRC-20

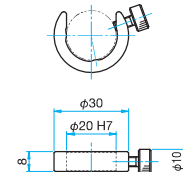

Clamp Screws (For post holders) Helicoidal 15mm Jacks / Helicoidal Post Holders

RS-CB
HCS-H / RSN

RS-CB

RoHS Catalog Code W6046

Clamps for high stability ball plunger post holders (BRS-12, BRS-20) and post holders (RS-12, RS-20, RS-30).

- Used to secure posts inserted in post holders.
- Use these screws as additions for post holders (RS model) that allow clamping with maximum three clamp screws to maximize holding strength.



Outline Drawing

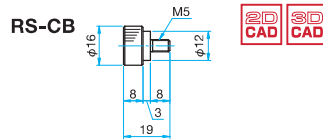

Guide

- ▶ High stability ball plunger post holders (BRS), post holders (RS)
Reference ▶ D042, D043

Attention

- ▶ This product is delivered only by mail.

Specifications

Primary material: Brass Finish: Chrome Plated	
Part Number	Quantity [Pieces]
RS-CB	5

HCS-H

RoHS Catalog Code W6047

Coarse adjustment Helicoidal Jack.

- The upper plate moves upward without rotation.
- With a helicoid screw system, smooth movement of about 15mm/rotation is possible.



Example of Combinations



Helicoidal 15mm jack connected to a post holder.

Outline Drawing

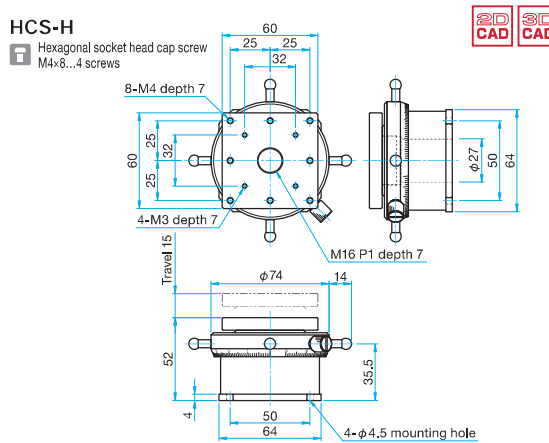

Specifications

Primary material: Aluminum Finish: Black Anodized		
Part Number	Load Capacity [N]	Weight [kg]
HCS-H	19.6 (about 2.0kgf)	0.45

RSN

RoHS Catalog Code W6048



Helicoidal Post Holder.

- Turning the height-adjustment rotary section allows movement of 10mm (about 5mm/rotation) in the height direction.
- To secure a holder, insert its post into the post holder, and clamp it using the two clamp screws on the side of the main body. The upper clamp screw on the side of the main body is designed to secure a post, and the lower clamp screw is designed to secure a helicoid ring.
- Fitted with a helicoid screw, these post holders can move the installed post up and down without turning it.

Outline Drawing

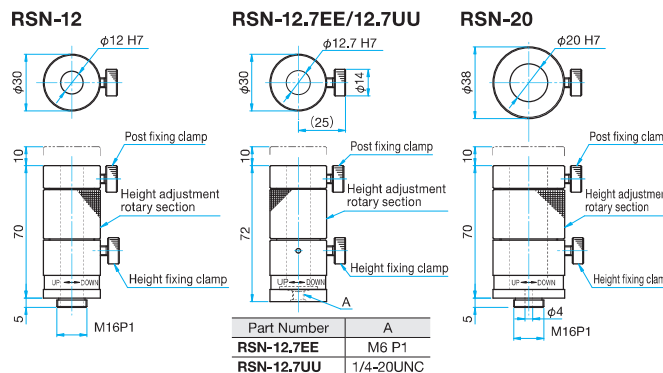

Attention

- ▶ Turning the height adjustment rotary section excessively may cause locking.

Specifications

Primary material: Aluminum Finish: Black Anodized			
Part Number	Inner Diameter [mm]	Diameter [mm]	Weight [kg]
RSN-12	φ12	φ30	0.16
RSN-12.7EE	φ12.7	φ30	0.16
RSN-12.7UU	φ12.7	φ30	0.16
RSN-20	φ20	φ38	0.21

Application Systems

Optics & Optical Coatings

Holders

Bases

Manual Stages

Actuators

Motoeized Stages

Light Sources

Index

Guide

Vibration Isolation Systems

Optical Tables

Darkrooms/ Dark Boxes

Optical Bases

Posts

Brackets

Adapters

Tools

Rod Mount Module / Z Angle Brackets

POSB/BLZ



Catalog Code W6051

Application Systems

Optics & Optical Coatings

Holders

Bases

Manual Stages

Actuators

Motoeized Stages

Light Sources

Index

Guide

Vibration Isolation Systems

Optical Tables

Darkrooms/ Dark Boxes

Optical Bases

Posts

Brackets

Adapters

Tools

Rod Mount Modules attach directly to the vibration isolator or laboratory bench. By attaching Z bracket at a right angle to the unit, horizontal adjustment will also be possible.

- The rod (material: stainless steel, finish: none) incorporates a vibration damping material.



Example

Outline Drawing

POSB-UN

- Hexagon socket head cap screw M4x12...4 screws

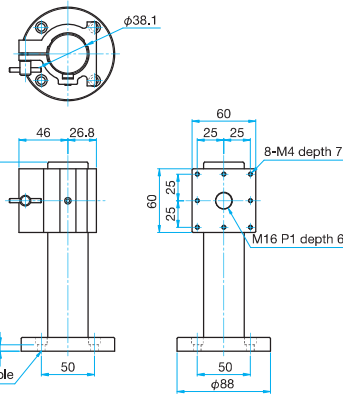

POSB-*UN*EE/UU

- Hexagon socket head cap screw M6x15...4 screws

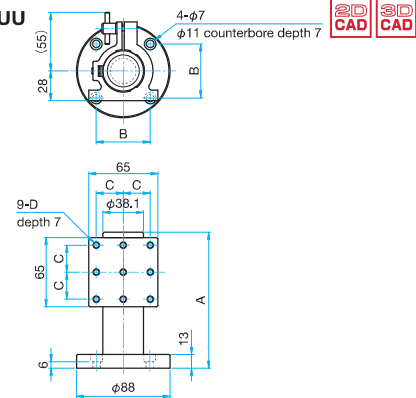

BLZ-60

- Hexagon socket head cap screw M4x12...4 screws

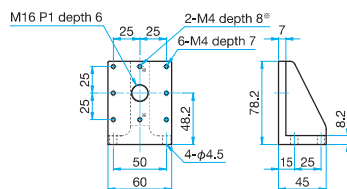

BLZ-65EE/65UU

- Hexagon socket head cap screw M6x15...4 screws(EE)
- Hexagon socket head cap screw 1/4-20UNCx5/8...4 screws(UU)

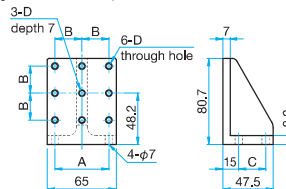

BLZ-6550EE/6550UU

- Hexagon socket head cap screw M6x12...2 screws(EE)
- Hexagon socket head cap screw 1/4-20UNCx1/2...2 screws(UU)

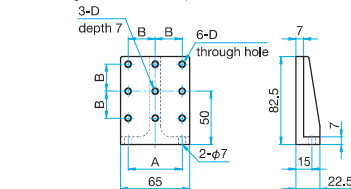

Specifications		Primary material: Stainless Steel (No finish) Coarse adjustment section material: Aluminum Finish: Black Anodized			
Part Number	A [mm]	B [mm]	C	D	Weight [kg]
POSB-177UN	177.8	—	—	—	2.1
POSB-355UN	355.6	—	—	—	3.7
POSB-177UN65EE	177.8	50	25	M6 P1	2.2
POSB-355UN65EE	355.6	50	25	M6 P1	3.8
POSB-177UN65UU	177.8	50.8	25.4	1/4-20UNC	2.2
POSB-355UN65UU	355.6	50.8	25.4	1/4-20UNC	3.8

Z Angle Brackets only		Primary material: Aluminum Finish: Black Anodized			
Part Number	A [mm]	B [mm]	C	D	Weight [kg]
BLZ-60	—	—	—	—	0.18
BLZ-65EE	50	25	25	M6 P1	0.2
BLZ-65UU	50.8	25.4	25.4	1/4-20UNC	0.2
BLZ-6550EE	50	25	—	M6 P1	0.14
BLZ-6550UU	50.8	25.4	—	1/4-20UNC	0.14

**Stainless steel pole with an M16P1 external thread at one end.
Used in combination with a cross clamp or rotary cross clamp.**

- Can be combined with other posts via a cross clamp or rotary cross clamp.
- The PO-12 model is secured with a wrench using a 17mm flat adjacent to the M16P1 external thread.
- Having a through hole on the side, the PO-20 model is secured using a wrench inserted into the hole.



Guide

► Custom sizes not listed in the catalog and additional processing. Contact our International Sales Division for more information. Use the Question Sheet for Special Order Posts.

► WEB Reference Catalog Code W6053



Outline Drawing

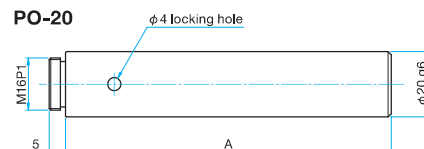
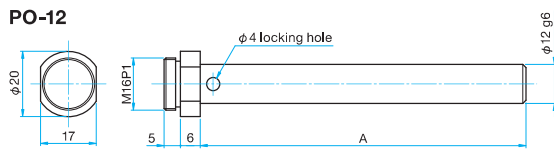

Specifications

Part Number	Diameter [mm]	A [mm]	Weight [kg]	Primary material: Stainless Steel Finish: None
PO-12-100	φ12	100	0.11	
PO-12-120		120	0.13	
PO-12-150		150	0.15	
PO-12-200		200	0.2	
PO-12-250		250	0.24	
PO-12-300		300	0.29	
PO-12-400		400	0.38	
PO-12-500		500	0.46	
PO-20-100	φ20	100	0.25	
PO-20-120		120	0.3	
PO-20-150		150	0.37	
PO-20-200		200	0.5	
PO-20-250		250	0.62	
PO-20-300		300	0.74	
PO-20-400		400	0.99	
PO-20-500		500	1.24	



Application Systems

Optics & Optical Coatings

Holders

Bases

Manual Stages

Actuators

Motoeized Stages

Light Sources

Index

Guide

Vibration Isolation Systems

Optical Tables

Darkrooms/ Dark Boxes

Optical Bases

Posts

Brackets

Adapters

Tools

Application Systems

Optics & Optical Coatings

Holders

Bases

Manual Stages

Actuators

Motoeized Stages

Light Sources

Index

Guide

Vibration Isolation Systems

Optical Tables

Darkrooms/ Dark Boxes

Optical Bases

Posts

Brackets

Adapters

Tools

Stainless steel posts. The RO model is fitted with an M4 or M6 external thread at one end, the ROU model is fitted with 1/4-20UNC inch external thread, and the ROC model is fitted with an M6P1 external thread.



- A hole through the side makes it easy to tighten using a wrench inserted into the hole.

Guide

- ▶ Custom sizes not listed in the catalog are available. Use the Question Sheet for Special Order Posts.
- ▶ [WEB Reference](#) [Catalog Code](#) W6053
- ▶ The ROU model can be used to mount cameras with 1/4-20 tapped holes.
- ▶ High stability ball plunger post holders (BRS), post holders (RS) [Reference](#) D042, D043



Outline Drawing

RO-6

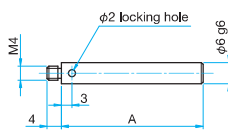

ROU-12

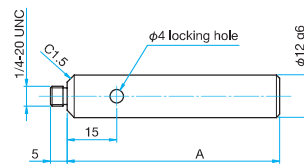

RO-20

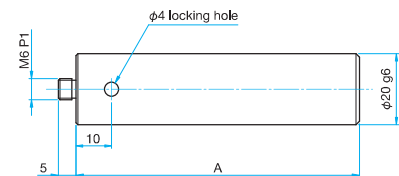

RO-12

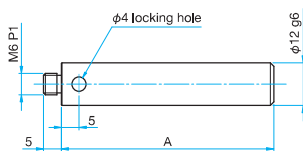

ROC-12

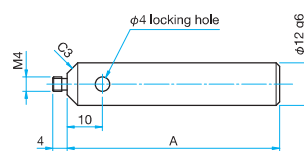

ROU-20

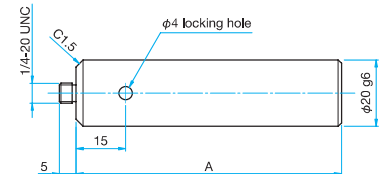

φ6 / φ12		Primary material: Stainless Steel Finish: None	
Part Number	Diameter [mm]	A [mm]	Weight [kg]
RO-6-15	φ6	15	0.004
RO-6-20		20	0.005
RO-6-25		25	0.006
RO-6-30		30	0.007
RO-6-40		40	0.008
RO-6-50		50	0.009
RO-12-20	φ12	20	0.02
RO-12-30		30	0.03
RO-12-40		40	0.04
RO-12-60		60	0.05
RO-12-80		80	0.07
RO-12-100		100	0.09
RO-12-120		120	0.11
RO-12-130		130	0.12
RO-12-150		150	0.13
RO-12-200		200	0.18
RO-12-250		250	0.22
RO-12-300		300	0.27
RO-12-400		400	0.36
RO-12-500		500	0.44
ROU-12-30	φ12 (C1.5)	30	0.03
ROU-12-60		60	0.05
ROU-12-80		80	0.07
ROU-12-100		100	0.09
ROC-12-30	φ12 (C3)	30	0.03
ROC-12-60		60	0.05
ROC-12-80		80	0.07
ROC-12-100		100	0.09

φ20		Primary material: Stainless Steel Finish: None	
Part Number	Diameter [mm]	A [mm]	Weight [kg]
RO-20-20	φ20	20	0.05
RO-20-30		30	0.07
RO-20-40		40	0.1
RO-20-60		60	0.15
RO-20-80		80	0.2
RO-20-100		100	0.25
RO-20-110		110	0.27
RO-20-120		120	0.3
RO-20-130		130	0.32
RO-20-150		150	0.37
RO-20-200		200	0.5
RO-20-250		250	0.62
RO-20-300		300	0.74
RO-20-400		400	0.98
RO-20-500	500	1.23	
ROU-20-30	φ20 (C1.5)	30	0.07
ROU-20-60		60	0.15
ROU-20-80		80	0.20
ROU-20-100		100	0.25



RO-EE/UU

Catalog Code **W6083**

Stainless steel posts.

In case of using this rod, without buying a new rod, it is possible to be set the holder or the like to the various optical axis height.

- The through-hole of the side of the rod is used to insert the hex wrench. By using this, it can be easily attached and detached to the holder or the like.
- Accessories can be selected from the type of M4 and M6 or inch type.



Example

Guide

- ▶ Custom sizes not listed in the catalog are available. Use the QuestionSheet for Special Order Posts. [▶ WEB Reference](#) Catalog Code W6053

Outline Drawing

RO-EE/UU

- special screw SC-M4-14EE...1 screws (CHS-M4-M6-5)(EE)
- special screw SC-8U-14UU...1 screws (CHS-1/4-8U-5)(UU)

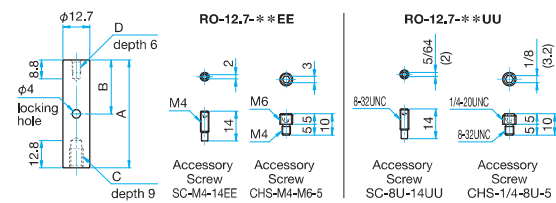

C: EE type M6P1, UU type 1/4-20UNC
D: EE type M4, UU type 8-32UNC

Specifications

Part Number		A [mm]	Weight [kg]
METRIC	INCH		
RO-12.7-25.4EE	RO-12.7-25.4UU	25.4	0.026
RO-12.7-38.1EE	RO-12.7-38.1UU	38.1	0.038
RO-12.7-50.8EE	RO-12.7-50.8UU	50.8	0.051
RO-12.7-76.2EE	RO-12.7-76.2UU	76.2	0.077
RO-12.7-101.6EE	RO-12.7-101.6UU	101.6	0.102
RO-12.7-152.4EE	RO-12.7-152.4UU	152.4	0.153
RO-12.7-203.2EE	RO-12.7-203.2UU	203.2	0.204
RO-12.7-304.8EE	RO-12.7-304.8UU	304.8	0.306

Primary material: Stainless Steel
Finish: None

CHS

Catalog Code **W6084**

CHS, as a conversion screw, is processed by different thread at both ends, in case of M6 or 1/4 inch for holder side and M4 or 8-32UNC for stand side are different, it can be used as a connecting screws for mounting.



- We will prepare the two types of screws INCH and METRIC.
- If you have misplaced the included screws for extension rod, it can be purchased separately.

Guide

- ▶ It is used for extension rod (RO-12.7-**-*),

Outline Drawing

CHS

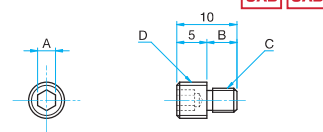

Specifications

Part Number	A [mm]	B [mm]	C	D	Quantity [Pieces]
CHS-M4-M6-5	3	5	M4	M6 P1	10
CHS-M4-M6-9	3	9	M4	M6 P1	10
CHS-1/4-8U-5	1/8 (3.2)	5	8-32UNC	1/4-20UNC	10
CHS-1/4-8U-9	1/8 (3.2)	9	8-32UNC	1/4-20UNC	10

Primary material: Stainless Steel
Finish: None

Dog Point Set Screws Cross Clamps

SC
CCHN

SC

Catalog Code W6085

Application Systems

Optics & Optical Coatings

Holders

Bases

Manual Stages

Actuators

Motoeized Stages

Light Sources

Index

Guide

Vibration Isolation Systems

Optical Tables

Darkrooms/ Dark Boxes

Optical Bases

Posts

Brackets

Adapters

Tools

We offer two types of M4 and 8-32UNC as a stop screw. One end of the screw serves as a full dog point, and can be used as a screwing side. In the case that the holder side and the stand side are same M4 or 8-32UNC, it will be used as the connecting screw. [Reference](#) D041



Guide

► It can also be used as an accessory of the rod (RO) and the post stand (PST).

Outline Drawing

SC

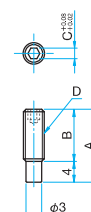

Specifications					Primary material: Steel Finish: chrome plating
Part Number	A [mm]	B [mm]	C	D	Quantity [Pieces]
SC-8U-14UU	14	10	5/64 (2)	8-32UNC	10
SC-8U-16UU	15.6	11.6	5/64 (2)	8-32UNC	10
SC-8U-18UU	17.5	13.5	5/64 (2)	8-32UNC	10
SC-8U-20UU	19.5	15.5	5/64 (2)	8-32UNC	10
SC-8U-21UU	21	17	5/64 (2)	8-32UNC	10
SC-M4-14EE	14	10	2	M4	10
SC-M4-16EE	15.6	11.6	2	M4	10
SC-M4-18EE	17.5	13.5	2	M4	10
SC-M4-20EE	19.5	15.5	2	M4	10
SC-M4-21EE	21	17	2	M4	10

CCHN

RoHS

Catalog Code W6054

Cross clamps connect two posts at right angles.

- Its split clamp structure allows firm clamping.



Outline Drawing

CCHN-6-6

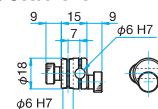

CCHN-12-6/CCHN-12.7-6

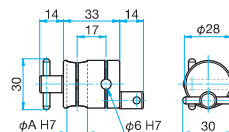

CCHN-12-12/CCHN-12.7-12.7

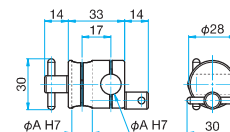

Specifications		Primary material: Aluminum Finish: Black Anodized
Part Number	Weight [kg]	
CCHN-6-6	0.021	
CCHN-12-6	0.065	
CCHN-12.7-6	0.065	
CCHN-12-12	0.06	
CCHN-12.7-12.7	0.06	
CCHN-20-12	0.128	
CCHN-20-20	0.11	

Part Number	A (mm)
CCHN-12-6	12
CCHN-12.7-6	12.7

Part Number	A (mm)
CCHN-12-12	12
CCHN-12.7-12.7	12.7

CCHN-20-12

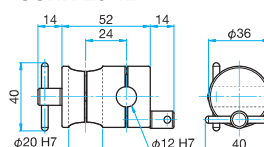

CCHN-20-20

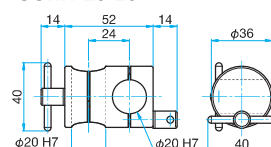

Rotary cross clamps connect two posts at an arbitrary angle.

- Its split clamp structure allows firm clamping.



Specifications		Primary material: Aluminum Finish: Black Anodized
Part Number		Weight [kg]
CRHN-6-6		0.032
CRHN-12-6		0.078
CRHN-12.7-6		0.078
CRHN-12-12		0.1
CRHN-12.7-12.7		0.1
CRHN-20-12		0.167
CRHN-20-20		0.196



Outline Drawing

CRHN-6-6

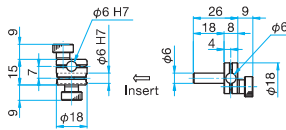

CRHN-12-6/CRHN-12.7-6

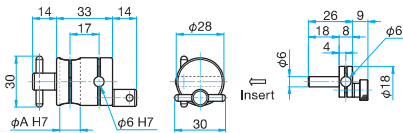

Part Number	A (mm)
CRHN-12-6	12
CRHN-12.7-6	12.7

CRHN-12-12/CRHN-12.7-12.7

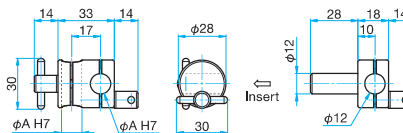

Part Number	A (mm)
CRHN-12-12	12
CRHN-12.7-12.7	12.7

CRHN-20-12

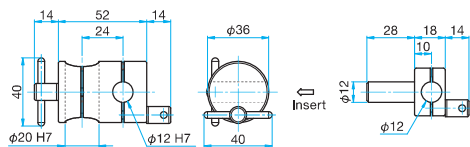

CRHN-20-20

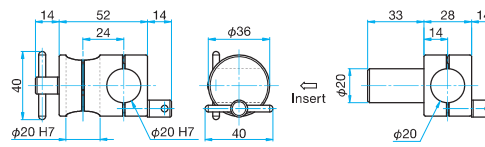

Application Systems

Optics & Optical Coatings

Holders

Bases

Manual Stages

Actuators

Motoeized Stages

Light Sources

Index

Guide

Vibration Isolation Systems

Optical Tables

Darkrooms/ Dark Boxes

Optical Bases

Posts

Brackets

Adapters

Tools